



Accutone Telephone Headset User Manual

This Guide Covers the Following Models;

- | | |
|--|---|
| - Accutone Model TM710 Monaural Headset | - refer to sections 1 through to 4, 6 and 7 |
| - Accutone Model TB710 Binaural Headset | - refer to sections 1 through to 4, 6 and 7 |
| - Accutone Model TB610 Heavy Duty Binaural Headset | - refer to sections 1 through to 4, 6 and 7 |
| - Accutone Model TM363DW Convertible Headset | - refer to sections 1 through 7 |
| - Accutone Model TM363VT Voice Tube Headset | - refer to sections 1 through to 4, 6 and 7 |

Many features are common to all models. When a specific instruction applies to a given model these are covered by referring to the sections listed above against each model.

Replacement parts and accessories are available from your usual supplier.

Index

Section No		Page
1.	Understanding your headset	1
1.a)	Different Types of Telephone Headsets	1
1.b)	Identifying key components of a telephone headset	1
1.c)	Wearing your headset	2
1.d)	Using the flexible microphone boom	2
2.	Using the quick disconnecter	2
3.	Installing your headset	2
3.a)	Direct connection	2
3.b)	Connection using the configuration box provided	2
3.c)	How to install and configure the C100 configuration box	2
4.	Using your headset	2
4.a)	Making calls	2
4.b)	Receiving calls	2
5.	Using the Accutone TM363 Convertible Head	2
6.	Trouble shooting	3
7.	Information & Product support line	3

1) UNDERSTANDING YOUR HEADSET

Before setting up your headset it is worth spending a few minutes getting to know how it works and what it can do.

1.a) Monaural and Binaural telephone headsets

Telephone headsets come in monaural (single ear piece shown in 1) and binaural (dual ear piece shown in 2) to suit different needs.

A monaural headset will be convenient for users who wish to be aware of their surroundings where as a binaural is better for people that need to concentrate when their environments are noisy and concentration is needed.

The most common styles of wearing headsets are over-the-head (as shown in 1 & 2) and over-the-ear (3) see section 7 for more info on over-the-ear headset use.



1.b) Identifying key components of a telephone headset

- | | |
|-----------------------------------|---------------------------|
| 1. Headband - metallic or plastic | 8. Quick disconnecter |
| 2. Stabiliser earpad | 9. Clothing clip |
| 3. Headset body | 10. Curly cord |
| 4. Rotatable microphone boom | 11. RJ.11 modular plug |
| 5. Speaker | 12. Flexible earloop |
| 6. Leatherette ear cushion | 13. Foam ear cushion |
| 7. Microphone capsule chamber | 14. Microphone windscreen |

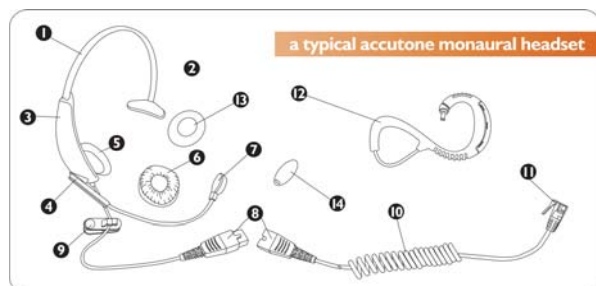

Please Follow the Instructions in This Manual to Ensure Successful Operation of Your Headset.

1.c) Wearing your telephone headset

To accommodate left or right ear wearing you can rotate the mic boom as shown in image A.

The headband can also be adjusted to position the stabiliser earpad in the correct and most comfortable position for you.

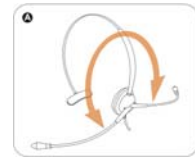

1.d) Using the flexible mic boom

Accutone's telephone headsets have rotatable and flexible mic booms which allow you to easily adjust the boom so the mic capsule is correctly positioned, see image right ©



2.) USING THE QUICK DISCONNECTOR

Each Accutone telephone headset comes with a quick disconnecter linking your headset portion to the modular plug cable (bottom cord). This is for your convenience, so you don't have to remove your headset when you want to leave your desk for a short while. Connect the cables as illustrated, until you hear a slight clicking sound.

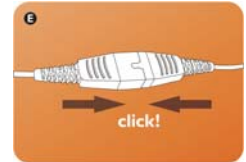

3.) INSTALLING YOUR HEADSET

There are two ways of connecting your Accutone headset to your telephone.

3.a) Direct connection

If you have a telephone with a dedicated headset port, simply plug the headset directly into the headset port on your telephone. You do not need to use the configuration box. Features such as mute and volume control will be controlled by your telephone. Please refer to the instruction manual for your telephone if you are unsure how to do this.

Please note your telephone handset must be fitted with a standard RJ11 plug (this is the type of plug used for most headset connections on corded telephones).

3.) Connection using the C100 configuration box provided

If you have purchased the C100 configuration box this will give you the additional benefits of switching between your headset and telephone handset as well as a mute facility.

3.a) Identifying key parts of your C100 configuration switch

- 1,2,3,4 - Configuration switch part 1
- A,B,C - Configuration switch part 2

3.b) How to install and configure the C100 configuration switch

1. Disconnect the handset cord from your telephone
 2. Connect the cable from the configuration box into the handset socket of your telephone
 3. Connect the handset cord into the socket on the configuration box
- Connect your headset to the socket on configuration box (4)

Configuration Switches

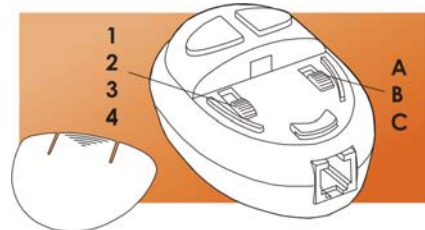

Handset/headset selection & Mute

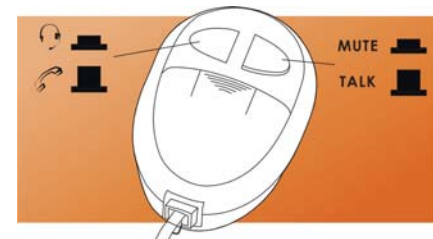

4.) USING YOUR HEADSET

4.a) Making calls

To make a call you will need to raise the telephone handset, this will place the telephone "off hook" and you should hear the dial tone through the headset, just dial the number you require.

When the call is finished replace the telephone handset to place the telephone "on hook".

4.b) Receiving calls

To receive a call when the telephone rings, put on your headset (if you are not already wearing it) and raise the telephone handset to accept the call and place the telephone "off hook".

When the call is finished replace the telephone handset to place the telephone "on hook".

Congratulations, you are now connected!

5.) USING THE ACCUTONE TM363 CONVERTIBLE HEADSET

To convert your TM363 from over-the-head use to over-the-ear hold the two areas indicated and pull the headband (1) away from the ear piece (2) in a vertical direction (To re-insert the headband simple insert the bottom part into the rubber ring at the top of the ear piece.) Now insert the plastic rod at the end of the ear loop (3) into the rubber ring at the top of the earpiece as shown. With little pressure, it should fit easily; stop when you feel resistance.

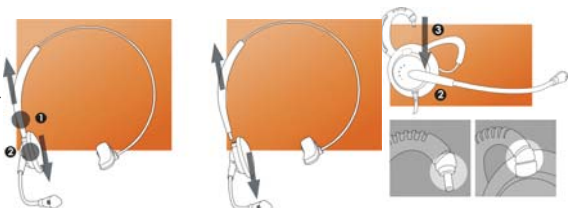

Please Follow the Instructions in This Manual to Ensure Successful Operation of Your Headset.

6.) TROUBLESHOOTING (USING CONFIGURATION BOX)

1. If you have problems such as a high pitched whine or crackling noise whilst using the headset, you may need to change the settings on your configuration box for the headset to work properly with your telephone / telephone system.
To do this, look at the top of the configuration box. There are two selector switches marked 1, 2, 3, 4, and A, B, C. These selectors create 12 possible settings for maximum compatibility. Try each setting one by one (for example 1+A, 2+A, 3+A) with the handset raised until you can hear a clear dial tone through the headset. If more than one setting gives a dial tone then choose the clearest setting.
2. If your caller is unable to hear you, check that your mute button is not depressed.
3. If you cannot use the telephone handset, check that you do not have the headset mode selected and that you have the handset and headset connected in the correct sockets.

7) INFORMATION!

For your safety we advise that you keep this headset and its components away from any liquids. Do not attempt to effect repairs yourself; seek qualified advice. Always operate at a safe volume level to protect your hearing. Take regular breaks when using telephone headsets.

Product support line

If, after following these instructions and carefully checking the settings, you require assistance please call 0871 200 2276 between 9.00am and 5.30pm Monday to Friday (except public holidays). Calls are charged at national rate

A copy of the Declaration of Conformity for this product can be found at www.easidirect.co.uk

Please Follow the Instructions in This Manual to Ensure Successful Operation of Your Headset.

 **Helpline 0871 200 2276**