

RIES

BT ACCESSO



# Extension Cord

## 10 METRES

Gives you the freedom to extend the distance of your telephone from the socket.



R I E S



# Extension Cord

## 10 METRES

B T A C C E S S O

### CONTENTS

- 10-metre extension cord

### INSTRUCTIONS

1. Remove the telephone cord from the wall socket (a).
2. Push the extension cord into the wall socket (b).
3. Plug the telephone cord into the other end of extension cord (c).

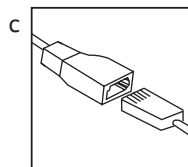
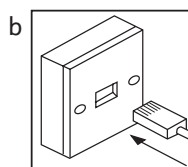
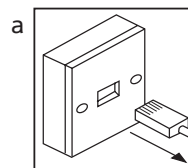

MADE UNDER GENERAL  
APPROVAL NUMBER  
NS/G/1235/W/100025/G/A25

### INFORMATION

For your safety we advise that if you are running cables you should take care to avoid any trip hazard, water ingress and proximity to mains cables. Length of cord quoted is typical and subject to manufacturing variations.

### ITEM

10-metre Extension Cord

### ITEM CODE

871825

### MADE IN

CHINA



5 016351 600665 >